

Cumberland County - Parcel: 1700 C 028.00

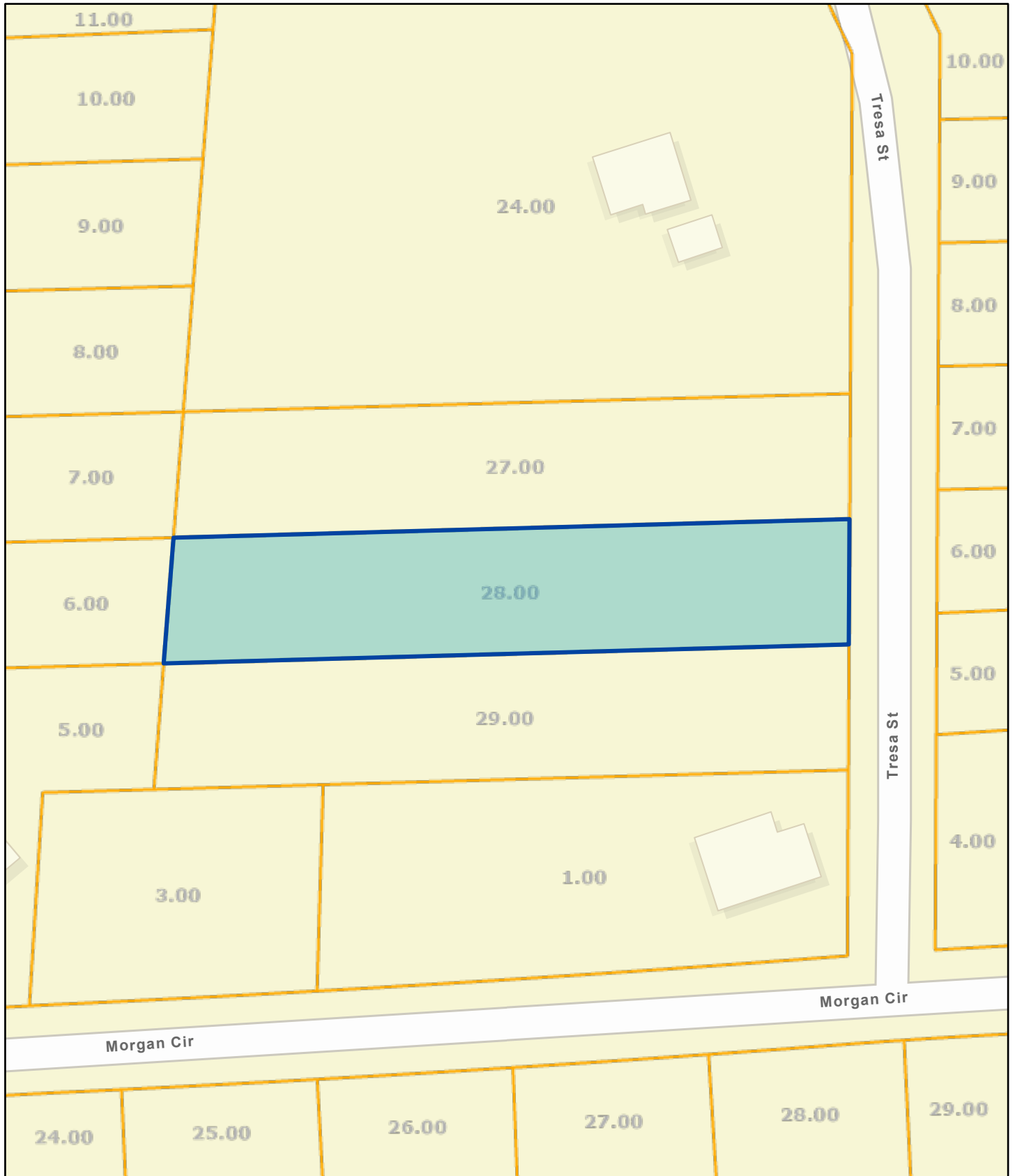

Date: April 21, 2024

County: Cumberland
Owner: LAKE PARK RESORT INC
Address: TRESA ST
Parcel Number: 1700 C 028.00
Deeded Acreage: 0
Calculated Acreage: 0
Date of TDOT Imagery: 2018
Date of Vexcel Imagery: 2023

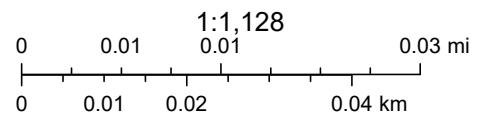

Esri Community Maps Contributors, Tennessee STS GIS, © OpenStreetMap, Microsoft, Esri, TomTom, Garmin, SafeGraph, GeoTechnologies, Inc, METI/ NASA, USGS, EPA, NPS, US Census Bureau, USDA, USFWS, State of Tennessee, Comptroller of the Treasury

The property lines are compiled from information maintained by your local county Assessor's office but are not conclusive evidence of property ownership in any court of law.